

WORKSafe® LIQUORCHECK SINGLE-USE BLOOD ALCOHOL CONTENT TEST KIT ALCOHOL BREATHALYZER

LiquorCheck
by WORKSafe®



- This breathalyzer is a single-use chemical breathalyzer that measures the level of alcohol in a person's exhaled air. The breathalyzer indicates whether this blood alcohol level is above or below the threshold for which the device is calibrated.

Each breathalyzer is made up of 2 elements:

- **THE BALLOON:** collects a precise volume of air exhaled by the person. This air is then emptied through a reagent tube.
- **THE REAGENT TUBE:** contains the chemical reagent which changes colour on contact with alcohol. Before using the test, the reagent is white and will remain white if there is no alcohol in the exhaled air. If enough alcohol is present, the reagent turns pink. The change from white to pink occurs when the blood alcohol level is equal to or greater than the calibration threshold of the breathalyzer.

INSTRUCTIONS FOR USE

Operating temperature: between 10°C and 40°C
Storage temperature: between -20°C and 70°C

PRODUCT CODE

925WSMLQC35

WORKSafe® Disposable Alcohol Check Breath Test Kit,
35µg Per 100ml Breath

Brand	WORKSafe®	Model	LiquorCheck
Type	Alcohol Breathalyzer	Manufacturer	France
Balloon Volume	1.3 liters	Balloon Size	L=190mm, W=185mm
Standards	Chemical Breathalyzer - NF X 20-702: 2014		

THE REAGENT TUBE

The reagent (Fig 1 - a) is placed in a glass tube (Fig 1 - b). This reagent is kept compressed by 2 perforated plastic reagent holder parts (Fig 1 - c). The glass tube is sealed at both ends with aluminium caps (Fig 1 - d).

Before using the breathalyser, push in the cap piercers (Fig 2 - e) to puncture the caps and to allow air to pass through when deflating the balloon.

FIGURE 1: Reagent tube WITHOUT cap piercers

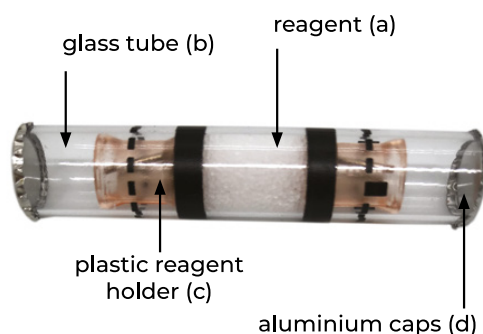
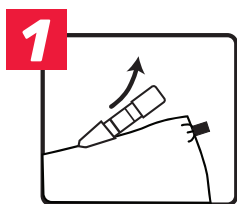

FIGURE 2: Reagent tube WITH cap piercers



INSTRUCTIONS



Remove the tube as shown.



Push the ends in as far as you can.



Blow up the bag with a single breath.

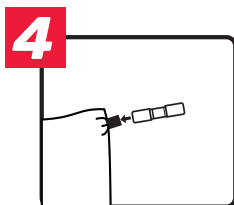

Insert the tube into the mouth of the bag.



Press all the air out of the bag for around 15 seconds, then remove the tube.



Wrap your hand around the tube. Keep in your hand for 2 mins.

READING THE RESULT:



Red Colour =

Breath alcohol level greater or equal to 35mg/100ml of breath – equivalent to 80mg/100ml of blood.

WARNING

Any results obtained from this test do not absolve you from responsibility if apprehended by law enforcement, and cannot be used as evidence in your favour in a court of law.